



44° 41' 13" N
11° 20' 17" E

FOR TRADITION
ONE STEP AHEAD

EXCAVATORS

WWW.ORSIGROUP.IT

HEADQUARTER

MASCARINO DI CASTELLO D'ARGILE (BO) ITALY



OUR DISTRIBUTION WORLD WIDE



OVER
40
YEARS
OF EXPERIENCE

OVER
530
DEALERS
WORLDWIDE

MORE THAN
129.000
MACHINES
SOLD WORLDWIDE

CERTIFICATIONS



ANTICORROSIVE TREATMENT

ANTICORROSIVE POWDER TREATMENT

- Shot Blasting SA Ø 2,5
- Primer application in zinc phosphate epoxy powder thickness 60-80 µm
- EXTRA polyurethane finishing powder (UV-resistant) thickness 60-80 µm polymerization at 180° for 20'
- Final dry thickness 120-160
- Orange colour RAL 2011
- Corrosivity class c5-i following DIN55633 and DIN EN ISO 12944-6 norms
- Salt spray resistance 2000h



RAW SHEET

GRITTED SHEET

SHEET COVERED WITH
POLYURETHANE ENAMEL

SURFACE COVERED WITH
ORANGE RAL 2011

ANTICORROSIVE LIQUID TREATMENT FOR MECHANICAL AND HYDRAULIC COMPONENTS

HIGH STRENGTH CYCLE

- Shot Blasting sa Ø 2,5
- Epoxy bi-component primer application in zinc CT90
- Expoprimer application CT113 grey 7035
- EXTRA bi-component polyurethane enamel application (UV-resistant)
- Final dry thickness 350-400 µm

STANDARD CYCLE

- Shot Blasting sa Ø 2,5
- Expoprimer application CT113 grey 7035
- EXTRA bi-component polyurethane enamel application (UV-resistant)
- Final dry thickness 180-200 µm

**“WHY AN EXCELLENT
PAINTING IS IMPORTANT”
BECAUSE IT KEEPS THE PRICE
OF THE MACHINE ON THE
SECOND-HAND MARKET.**



N.B. These cycles are applied on all our equipment.





WHY WE USE HARDOX?

Hardox® 450

The most popular abrasion-resistant steel with excellent structural properties.

Hardox® 450 is an abrasion-resistant steel with a nominal hardness of 450 HBW. Hardox® 450 combines good bendability and weldability with an option for guaranteed impact toughness (Hardox® 450 Tuf).

The products can be used in many different components and structures that are subject to wear. Hardox® 450, with an extra 50 Brinell hardness over our 400 grade, provides better dent and abrasion resistance as well as longer wear life, so you can achieve even greater savings.



WHY WE USE STRENX?

Superior properties

Strenx® steel has extremely consistent properties, ensuring precision and efficiency in the workshop.

If you think all steel is basically the same, Strenx® performance steel will change your thinking. Strong and reliable from surface to core, Strenx® steel features exceptional surface quality as well as impressive thickness and flatness tolerances verified by the Strenx® guarantees. The steel's properties - yield and tensile strength, bending performance, impact toughness - are carefully tested to ensure reliability and consistency in every delivery.

TECHNICAL INFORMATION



ORSI V3.1

Compact valve group proportioned to the oil flows necessary to the machineries. Just projected by ORSI's technical dept. to satisfy the needs of machineries attached to excavators. Anticavitation valve, max valve and flow divider; exhaust drainage collector and only 2 hoses for connection to the excavator (ingoing oil and direct return to the tank).



HYDRAULIC GEAR MOTOR

Hydraulic gear motor in cast iron. Designed to have excellent mechanical characteristics with a rigid and compact structure that guarantees excellent reliability and high volumetric performance even at high working pressures. Max 250 BAR.



REXROTH HYDRAULIC PISTON ENGINE

Constant displacement hydraulic motors with rotating assembly with axial conical pistons and inclined cylinder block. Very high quality, very high performance. Variable displacement hydraulic motors with rotating assembly with axial conical pistons and inclined cylinder block. By adjusting the inclined cylinder block, it is possible to modify the torque and the displacement continuously.



ASPORTABLE OSCILLATING PLATE

Autolevelling system specially bolted to the chassis with the same saddle attack drill. Possibility to remove it quickly for a greater accuracy and better operation in the profiling of the hedges. Also equipped with a locking pin in case of occasional use in the vertical profiles.

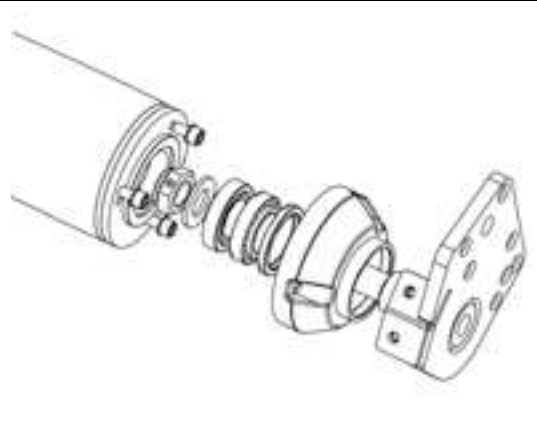
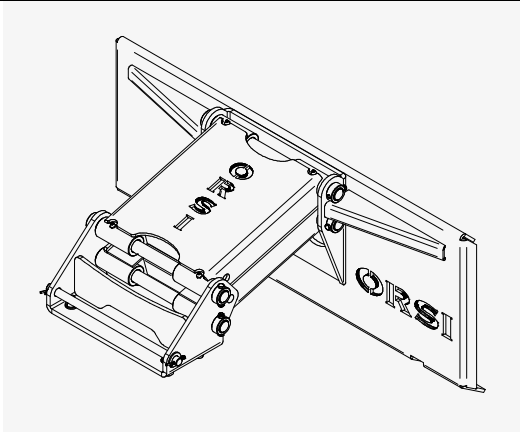

OSCILLATING HITCH WITH HYDRAULIC SIDE SHIFTA

Universal hitch plate for miniskids with integrated floating system, for a better adherence of the shredder to the working plane. Fixed to the shredder by means of a bolted stirrup for maximum flexibility over time.

PROFESSIONAL ROLLER

Professional support roller Ø 140 mm with 4 opposed tapered roller bearings. Interchangeable central body.

MOUNTING BRACKETS

Attachment bracket for excavator supplied on request (without pins).

ADAPTERS

ROTOR

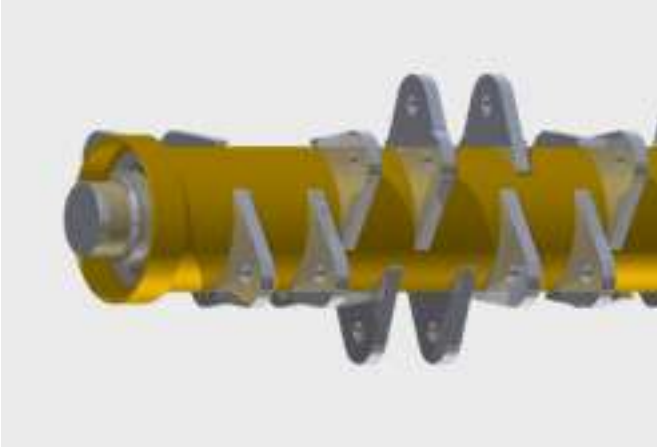

HELICOCUT

Rotor with helical cutting system design with 6 rows of tools, designed to reduce the efforts and give more homogeneity to the cut and therefore better performance. Possibility to change 4 or 5 types of tools on the same rotor to always have the more suited tool for the type of work to deal with. More efficiently with less effort.

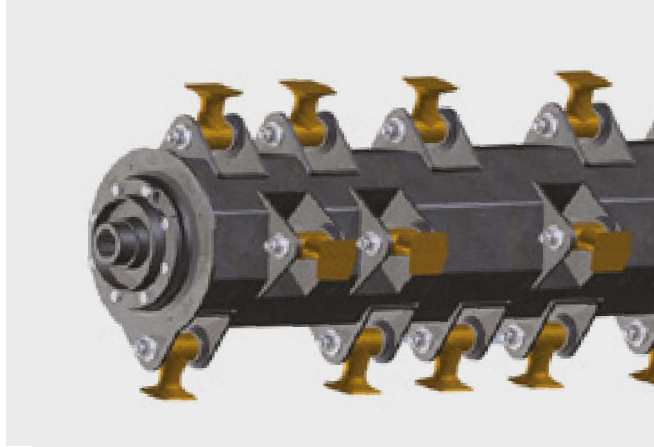

SEMIFOREST WITH ROTARY HAMMERS

Rotor with retractable rotating hammers specially designed to make more efficient the normal flail heads in the hard work of deforest. Designed by ORSI to allow small excavators, spiders and all those machines able to climb the huge slopes of the high mountains, to clean small spaces. Mountable as standard or as a spare part at a later time, it becomes the ideal friend when the going gets tough and the spaces are narrow and cramped.



FOREST ROTOR WITH ROTATING HAMMERS

Professional forest rotor for deforestation. Suitable for aggressive work of plants abatement up to 12 cm in diameter. It is also ideal for cleaning the floor. Using the tool in both working directions will be created a clean surface and free from dangerous protrusion.



FOREST ROTOR WITH FIXED TEETH

Professional FOREST rotor for big deforestation. Born with helicoidal system and two spirals, it uses interchangeable tools in tungsten. Maximum aggression and excellent performance make this rotor the most powerful tool for heavier works.

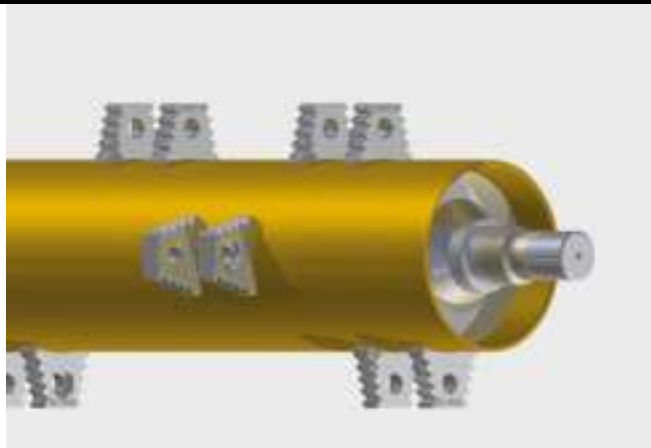

“VENTILATOR” ROTOR

Electronically balanced. Forest type tool holders moulded in boron steel



ROTOR WITH “FLANGES TOOL LIMITER” (FTL) TECHNOLOGY

Excellent performance and speed with less power requested.

The working depth of the tools is limited by steel flanges, reducing the requested power and still guaranteeing high performances.



1,2 ÷ 2,5 ton.



max Ø 2,5 cm

A mulcher for mini excavators, equipped with a hammers or knives rotor.



The smallest mulcher in our construction range, designed for cleaning bushes and shrubs.

The mulcher can be equipped with either a standard 8 cc motor or with an 11 cc or 16 cc one, and it is intended to be used on 1.2 to 2.5 t excavators.

BASIC 80

HYDRAULIC CUTTING HEAD



	RPM		
8 c.c.	2.500 - 3.000	20÷25 lt/min	220 max BAR
11 c.c.	2.500 - 3.000	28÷33 lt/min	220 max BAR
16 c.c.	2.500 - 3.000	40÷48 lt/min	220 max BAR

STRENGTH POINTS



REMOVABLE OSCILLATING PLATE



ORSI V3.1





DOUBLE-ROW SELF-ALIGNING
BALL BEARINGS



BASIC 80

PROFESSIONAL SERIES

BASIC 80		A	B
TECHNICAL SPECIFICATIONS			
Working width		80 cm	80 cm
Overall width		95 cm	95 cm
Machine weight*		75÷100 kg	75÷100 kg
Direct transmission		✓	✓
		*variable weight based on the layout	
tools	 Knives A max Ø 1,5cm	N° 40	-
	 Hammers B max Ø 2,5 cm	-	N° 20

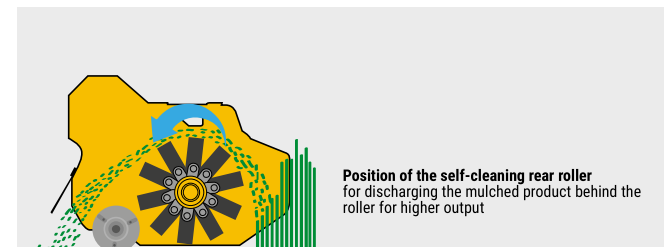

BASIC 80		A	B
MACHINE			
Rear roller Ø 100 cm adjustable in height		✓	✓
Replaceable skids		✓	✓
Removable oscillating plate		✓	✓
Standard mounting brackets (no pins)		•	•
Adapters		•	•
TRANSMISSION			
VARISEAL engine with external drainage		✓	✓
Rotor with possibility of use 2 types of tools		✓	✓
Double-row self-aligning ball bearings		✓	✓
Unidirectional rotor rotation		✓	✓
HYDRAULIC SYSTEM			
One way valve on return		✓	✓
ORSI V3 1-1/2: valve of max. pressure + anticavitation valve + flux regulator, 3 connecting hoses to the machine. Max backpressure on oil drainage = 12 BAR		✓	✓





2,5 ÷ 7 ton.



max Ø 5 cm



A mulcher that can be equipped with either a 16 cc motor or with a 22 cc or 27 cc one, and it is intended to be used on excavators from 2.5 to 7 t. This mulcher is designed for cleaning bushes and shrubs up to 5 cm in size, and it has a wide range of tools.

The "BELT" version comes with a pulley transmission instead of a direct motor.



INDUSTRIAL

HYDRAULIC CUTTING HEAD

	RPM		
16 c.c.	2.500 - 3.000	40÷48 lt/min	220 max BAR
22 c.c.	2.500 - 3.000	55÷65 lt/min	220 max BAR
27 c.c.	2.500 - 3.000	68÷81 lt/min	220 max BAR

STRENGTH POINTS



REMOVABLE OSCILLATING PLATE



REAR ROLLER PROF Ø 140 mm
with 4 bearings with tapered rollers, mud scraper
and interchangeable central part.







ORSI V3.1



**DOUBLE-ROW SELF-ALIGNING
BALL BEARINGS**



INDUSTRIAL			80	105	125	105 BELT	125 BELT
TECHNICAL SPECIFICATIONS							
Working width			80 cm	105 cm	125 cm	105 cm	125 cm
Overall width total			105 cm	130 cm	150 cm	125 cm	145 cm
Machine weight*			250÷300 kg	270÷320 kg	300÷350 kg	270÷320 kg	300÷350 kg
Direct transmission			✓	✓	✓	-	-
Belts transmission			-	-	-	2 cinghie	2 cinghie
tools		D max Ø 3 cm	N° 32	N° 40	N° 48	N° 40	N° 48
		O max Ø 3 cm	N° 32	N° 40	N° 48	N° 40	N° 48
		E max Ø 4 cm	N° 16	N° 20	N° 24	N° 20	N° 24
		F max Ø 4 cm	N° 16	N° 20	N° 24	N° 20	N° 24
		N max Ø 5 cm	N° 16	N° 20	N° 24	N° 20	N° 24

INDUSTRIAL			80	105	125	105 BELT	125 BELT
MACHINE							
Rear roller Ø 140 mm with 4 tapered roller bearings and interchangeable central body thickness 6 mm, adjustable in height			✓	✓	✓	✓	✓
Replaceable skids			✓	✓	✓	✓	✓
Blade cutting system			✓	✓	✓	✓	✓
Front and rear protection rubber			✓	✓	✓	✓	✓
Removable oscillating plate			✓	✓	✓	✓	✓
Mechanical rotation 180° (A.)			•	•	•	•	•
Hydraulic rotation 180° (n°2 hydraulic hoses) (B.)			•	•	•	•	•
Standard mounting brackets (no pins)			•	•	•	•	•
Adapters			•	•	•	•	•
Selflevelling "universal" skid coupler			•	•	•	•	•
Coupler for loaders/ telescopic lifters/ backhoes			•	•	•	•	•
TRANSMISSION							
VARISEAL engine with external drainage			✓	✓	✓	✓	✓
"Helicocut" rotor			✓	✓	✓	✓	✓
Double-row self-aligning ball bearings			✓	✓	✓	✓	✓
Unidirectional rotor rotation			✓	✓	✓	✓	✓
HYDRAULIC SYSTEM							
One way valve on return			✓	✓	✓	✓	✓
ORSI V3.1-1/2: valve of max. pressure + anticavitation valve + flux regulator. 3 connecting hoses to the machine. Max backpressure on oil drainage = 12 BAR with engine 16-22 cc.			✓	✓	✓	✓	✓
ORSI V3.1-3/4: valve of max. pressure + anticavitation valve + flux regulator. 3 connecting hoses to the machine. Max backpressure on oil drainage = 12 BAR with engine 27 cc.			✓	✓	✓	✓	✓

INDUSTRIAL

PROFESSIONAL SERIES

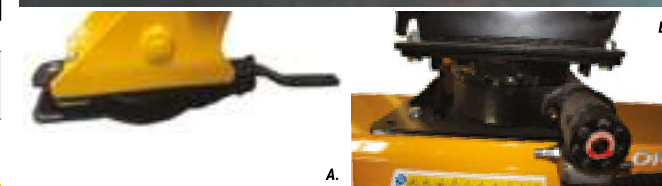
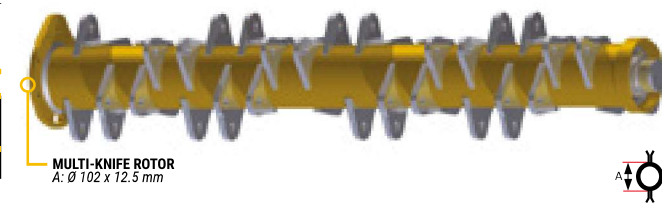
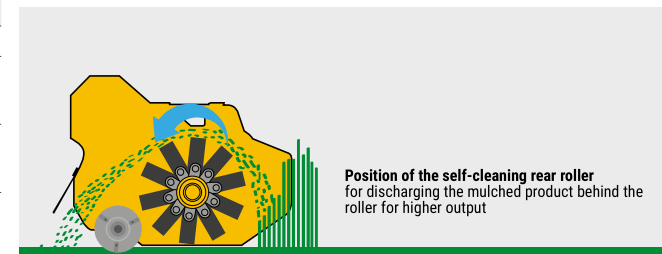





« The first Orsi Mulcher was purchased by my family about 25 years ago. The main quality we were looking for was reliability and performance of the machines in very difficult field conditions. The ORSI machines we have had are as reliable as possible, and have always done the work in the fields very well and importantly, we are extremely happy with the service. »

Azienda Agricola Boselli
Daniele e Filippo (BOLOGNA) Italia



ORSI GROUP S.R.L.

Via S. Andrea, 2A
Mascarino di Castello d'Argile
40050 / BOLOGNA / ITALY
Ph. +39 051 6867072
Fax +39 051 6867104

info@orsigroup.it
www.orsigroup.it